



At the heart of the image

DIGITAL SLR CAMERA

D50





"I'm looking for a camera that makes it easy to capture beautiful, natural-looking colors."

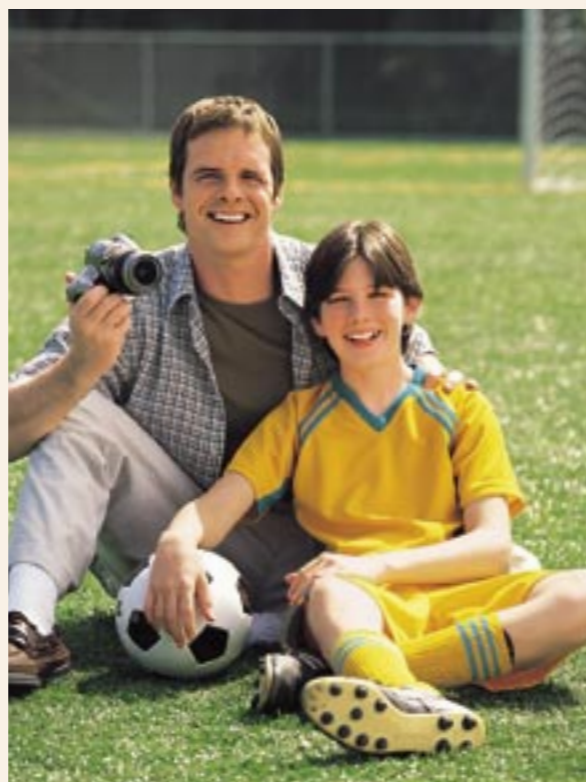

"Facial expressions change in an instant, but I want to catch them as they happen."



"I like beautiful landscapes, and I want to capture every detail."



"I want to take the best shots I can of the special people and the special things in my life."

Whatever the occasion, you'll capture the moment with the power of Nikon digital SLR

Special moments in life seem to fly by so quickly, which is why it's important to be able to capture them with the best possible quality, and with ease. Nikon provides the solution by coupling its proven digital and photographic technologies with interchangeable Nikkor lenses to deliver exquisite picture quality and thoroughly satisfying performance. Now it's easier for everyone who likes to take pictures to enjoy the benefit and excitement of high-performance digital SLR photography – with the Nikon D50.



- 6.1 effective megapixel performance
- Automated Digital Vari-Programs including new "Child" mode
- State-of-the-art autofocus and autoexposure systems
- 2.5 frames per second, up to 137 frames*
- Instant response – 0.2 sec. startup
- Maximum 1/4,000 sec. shutter speed
- Large, clear 2.0-inch LCD monitor
- Easy-to-use menu design
- Compact design for comfortable operation



D50

*Using JPEG NORMAL – Large settings, and a SanDisk Ultra II SD memory card (256MB). The number of continuous shots possible in a single burst may be fewer depending on the type of SD memory card used.

Advanced features to put truly great photos within your reach

Optimized settings for simple, sure results

Scene-optimized Digital Vari-Programs with a newly added "Child" mode help simplify picture taking.



Superior picture quality with every shot

A 6.1 effective megapixel CCD image sensor ensures consistent results, and Nikon's 5-area autofocus system provides superior precision and improved focus tracking.



Ready in an instant, anytime

With a power-up time of just 0.2 seconds, the D50 is always ready to capture that special moment, and it's also ready for rapid-action shots – 2.5 fps for a burst of up to 137 pictures.*

*Using JPEG NORMAL – Large settings, and a SanDisk Ultra II SD memory card (256MB). The number of continuous shots possible in a single burst may be fewer depending on the type of SD memory card used.



Your go-anywhere companion

The compact, lightweight body is well balanced and designed for comfortable operation.



Outstanding flexibility

Interchangeable lenses – including Nikon's extensive family of AF and DX lenses – enhance your creative options.



Taking photography one step further

Nikon's Creative Lighting System and versatile software options extend your photographic possibilities even further.



Easy to see, easy to use

The large 2.0-inch LCD presents clear and helpful on-screen information, while intuitive help dialogs provide on-the-spot reference to menu selections.





Stunning image quality and beautiful color made easy

Behind every great picture taken with the D50 is a sophisticated system that monitors shooting conditions precisely and optimizes camera settings automatically. Helping you take full advantage of that sophisticated system are seven tailored Digital Vari-Program modes. These include the innovative “Child” mode, which is designed to take more natural-looking photos of children by vividly rendering clothing and background details while keeping skin tones soft and natural.

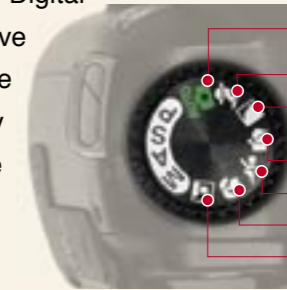

Digital Vari-Program modes

- Auto** – press the shutter release, and the camera does the rest
- Portrait** – bring out the best in people
- Landscape** – skies, forests, nighttime landscapes, photos of nature
- Child** – kids’ snapshots with vivid detail
- Sports** – capture fast-moving action
- Close-up** – clear images of small objects
- Night portrait** – balance subject and background in low light



Automated Digital Vari-Programs

The convenient program dial handles certain settings automatically, according to the type of shot and the photographic conditions. The new “Child” mode is one of seven choices, each of which automatically sets white balance, sharpness, contrast, color saturation and hue to help you achieve the best image in just about any situation.

Auto ISO

The sensitivity level is automatically set for each mode from within the camera’s range of 200-1600 (ISO equivalent). Manual ISO control is also available via custom setting.

Auto white balance

Washed-out photos and overly dark photos are minimized, as precise white balance is ensured by a 420-pixel RGB sensor that meters lighting levels across the entire picture frame before the camera’s shutter fires.

Color modes

Get the ideal color palette for any situation, as you choose from three different color modes depending on your subject matter. You can give priority to natural-looking skin tones, vivid landscape colors, or a wide color range suited to retouching or digital processing.

Image enhancement

For greater control over your final results, image enhancement options can give you added sharpness, brighter colors or a softer feel, all depending on how you want the final photo to look.

- Image quality mode: RAW (NEF)
- Lens: AF-S DX Zoom-Nikkor 55-200mm f/4-5.6G ED
- Exposure mode: Digital Vari-Program [Child], 1/320 second, f/6.3
- White balance: Auto
- Sensitivity: ISO-equivalent 200



Portrait mode



Sports mode



Close-up mode



Landscape mode



Night portrait mode



Auto mode



Clear, sharp focus on fast-moving subjects



When you need to capture the instant – whether it's a winning goal or a post-game celebration – quick camera response is absolutely crucial. The D50 is ready the moment you need it, and it won't let you down no matter how fast the action is moving.

Advanced autofocus system

The latest evolution of Nikon's 5-area Multi-CAM900 autofocus system combines proven broad frame coverage and class-leading low light detection with an AF-A automated servo selection mode, which switches smoothly between AF-S (single-servo autofocus) and AF-C (continuous-servo autofocus) in accordance with subject motion within the frame, to make it easier and more precise to lock onto subjects with sharp focus, whether they are still or moving. Additionally, the D50 offers a selection of three AF area modes (Single Area, Dynamic Area AF, and Closest Subject Priority Dynamic Area AF), and a specific focus area can be selected manually through simple operation of the multi-selector on the camera's back.

Continuous shooting at 2.5 fps

Continuous shooting capability of 2.5 frames per second lets you capture every moment of the action. And the camera's fast image

processing and buffer memory handling mean that you can take up to 137 photos in a single burst.*

*Large settings, and a SanDisk Ultra II SD memory card (256MB). The number of continuous shots possible in a single burst may be fewer depending on the type of SD memory card used.

Instant response

The D50 is ready to go when you are, with an almost-instant response time of 0.2 seconds after you turn on the power.

Fast shutter speeds

The electronic shutter has a maximum speed of 1/4,000 second, with 1/500 second flash sync speed plus fast curtain action for consistent results at high-speed shutter settings.



- Image quality mode: RAW (NEF)
- Lens: AF-S DX Zoom-Nikkor 55-200mm f/4-5.6G ED
- Exposure mode: [M], 1/640 second, f/5.6
- White balance: Auto
- Sensitivity: ISO-equivalent 200



- Image quality mode: RAW (NEF)
- Lens: AF-S DX Zoom-Nikkor 18-55mm f/3.5-5.6G ED
- Exposure mode: Digital Vari-Program [Landscape], 1/40 second, f/7.1
- White balance: Auto
- Sensitivity: ISO-equivalent 400

6.1 effective megapixel CCD

The camera's DX Format CCD image sensor produces pictures with high resolution for superb detail, and with excellent color fidelity across a wide dynamic range. The CCD itself is large in size (23.7 x 15.6mm), and the resulting images are a big 3,008 x 2,000 pixels, so even large-format prints and cropped photos show fine detail.



Advanced autoexposure system

The D50 uses the sophisticated 3D Color Matrix Metering II system, based on a 420-pixel RGB sensor for extremely accurate exposure control. Newly developed exposure evaluation algorithms detect highlights and shadows in the frame, and compensate for them to prevent under- or overexposure.



Histograms make it quick and easy to confirm proper exposure as you shoot.



You can zoom in on your photos as soon as you take them, to confirm proper focus.

State-of-the-art digital processing

Nikon's exclusive LSI processor brings everything together, maintaining sharp details and pure colors while optimizing white balance, tone and color control. Real-time noise reduction during long-exposure shots enhances picture quality.

2.0-inch LCD display and user-friendly menus

Camera settings are clear and intuitive, with extensive help dialogs and simple graphic- and text-based menus displayed on the bright 2.0-inch LCD monitor. The monitor is also used for image playback, with convenient image zoom with scrolling, thumbnail displays and automatic slide shows.

Light weight and compact size

The compact camera body is finely balanced and ergonomically designed to be comfortable in the hand. Easy-to-reach command dials and other controls allow for smooth, one-handed operation. And a long-life battery lets you take approximately 2,000 shots between recharges*.

*Achieved under following test conditions:
Fully charged EN-EL3 battery; temperature of 20° C/68° F; AF-S DX Zoom-Nikkor 18-55mm f/3.5-5.6G ED lens; continuous shooting mode; continuous servo autofocus; image quality set to JPEG BASIC; image size set to Medium; shutter speed 1/250 s; shutter-release pressed half way for three seconds and focus cycled from infinity to minimum range three times; after six shots, monitor turned on for five seconds and then turned off; cycle repeated once exposure meters have turned off.

Superbly rendered detail and precise exposure control

The emotional power of a great photograph is in the detail – the individual leaves of a distant tree or the subtle color changes of a sunset. The D50 captures the scene with remarkably sharp resolution and clarity, even under complex shooting conditions.



- Image quality mode: RAW (NEF)
- Lens: AF Micro-Nikkor 60mm f/2.8D
- Exposure mode: [M], 1/800 second, f/13
- White balance: Auto
- Sensitivity: ISO-equivalent 200





- Image quality mode: RAW (NEF)
- Lens: AF-S DX Zoom-Nikkor 18-55mm f/3.5-5.6G ED
- Exposure mode: [A], 1/60 second, f/8
- White balance: Auto
- Sensitivity: ISO-equivalent 200

Nikkor lenses

When it comes to lenses, Nikon quality makes a real difference. The D50 works seamlessly with the full range of high-quality AF and digital-dedicated DX Nikkor lenses, well known in the photography world for their superb color reproduction, razor-sharp clarity and excellent autofocus capabilities.



Two compact lenses to perfectly match the D50:

- AF-S DX Zoom-Nikkor 18-55mm f/3.5-5.6G ED
- AF-S DX Zoom-Nikkor 55-200mm f/4-5.6G ED



18mm



200mm

Creative lighting options

The camera's built-in Speedlight flash provides wide flash coverage and supports FV Lock to maintain measured flash levels while you recompose a shot. If you wish to create a complex setup with multiple light sources, the D50 can be used with Nikon's Creative Lighting System. This is an advanced wireless system where up to four groups of Speedlights (optional SB-600 or SB-800) can be centrally controlled from an SB-800 Speedlight mounted on the D50's hot shoe, with different flash modes available for each group of lights.



SB-600

SB-800

The flexibility and freedom of digital SLR

When you want to reproduce the images you see in your mind's eye, there's nothing to match an SLR, with its choice of lenses and its support of creative lighting options. The D50 draws on Nikon's impressive SLR heritage to put the full power of digital SLR in your hands.



- Image quality mode: RAW (NEF)
- Lens: AF-S DX Zoom-Nikkor 18-55mm f/3.5-5.6G ED
- Exposure mode: [A], 1/60 second, f/11
- White balance: Flash
- Sensitivity: ISO-equivalent 200
- Speedlight settings
Master: i-TTL
Remote A: i-TTL
Remote B: i-TTL



Take full advantage of the convenience of the digital format

PictBridge

PictBridge is the quick and easy way to connect to any compatible printer using the supplied USB cable, and print a shot directly from your camera. Page setup is also supported from within the camera.

Fast data transfer

The camera comes with the USB 2.0 Hi-Speed interface; enabling fast data transfer speeds from camera to computer.

SD memory cards

Data is stored on the popular SD memory card. Data transfer is fast, and the small, thin size makes it easy to carry around spare cards.

Small picture

This feature lets you save photos within the camera in small sizes suited to Internet use – either for email attachments or for placement on web pages. Available sizes are 640x480, 320x240, and 160x120 pixels.

PictureProject

The supplied PictureProject software provides easy-to-use image-management and editing tools to use on your Windows or Macintosh computer. Automatic importing of photos is as simple as connecting the camera to your computer, and you'll also have quick access to slide-show, mail, as well as CD and DVD burning functionality via handy buttons.

The software also supports optional plug-ins for added flexibility. nik Color Efex Pro 2.0 Express Edition includes fifteen filters to add various artistic effects to your photos. PictureProject DVD Show allows you to automate the process of editing movie clips and still images, making it easy to add special effects and music. (DVD Show is only available for Windows)

Capture NX software* (optional)

Capture NX unleashes exciting potential for Nikon Electronic Format (NEF) files, JPEGs and TIFF images, too. Refined through revolutionary U Point-powered "Control Points", it greatly simplifies the selection of objects, colors or areas – supporting highly accurate alterations to myriad image elements, while preserving the integrity of the original image data.



Capture NX



PictureProject

Handy camera accessories options

Remote control

The Wireless Remote Control ML-L3 (optional) can trigger the shutter without disturbing the camera when you're taking shots at slow shutter speeds.



Speedlight System

Powerful, full-featured with i-TTL flash control for use with Nikon's Creative Lighting System.



Power Accessories

- Rechargeable Li-ion Battery EN-EL3a (supplied)
- Rechargeable Li-ion Battery EN-EL3e
- Quick Charger MH-18a (supplied)
- Multi Charger MH-19
- AC Adapter EH-5



System Chart

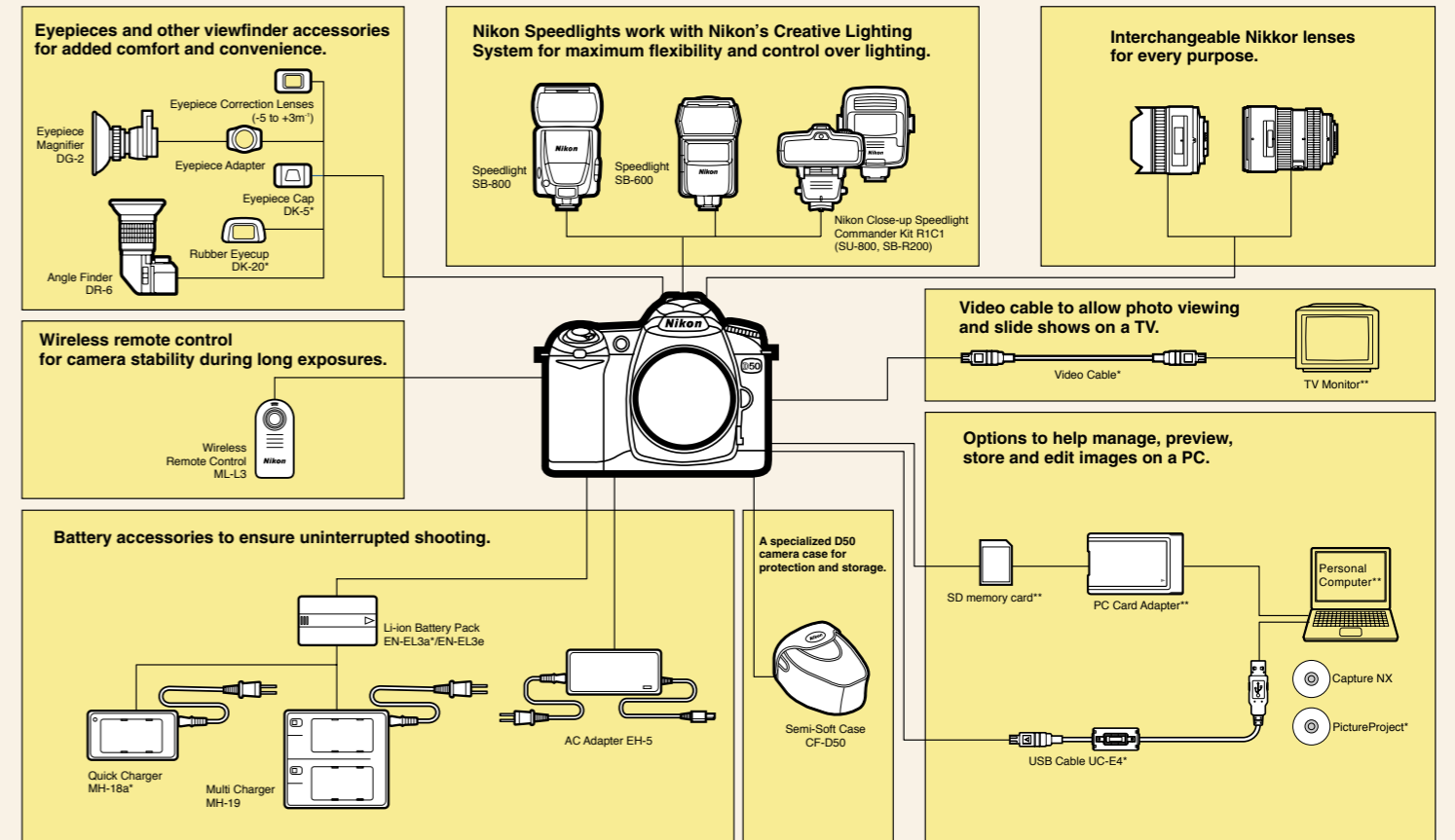

PictureProject System Requirements



OS	Macintosh: Mac OS X version 10.1.5 or later (10.2.8 or later required for "Burn Disc" function) / Windows: Windows XP Home Edition/Professional, Windows 2000 Professional, Windows Me, Windows 98 SE pre-installed models
RAM	64MB or more recommended (128MB or more with RAW images or muvee* option)
Hard disk	60MB required for installation
Display	800 x 600 or larger with 16-bit color (full color recommended)
Others	CD-ROM drive required for installation. Write-capable drive required for "Burn Disc" function. Only built-in USB ports are supported.

*for Windows

Capture NX System Requirements

OS	Macintosh: Mac OS X (version 10.3.9 or later) Windows: Windows XP Home Edition, Windows XP Professional, Windows 2000 Professional.
RAM	256 MB minimum (1.0 GB or more recommended).
Hard disk	200MB required for installation
Display	800 x 600 pixels (1024 x 768 or more recommended) with 16-bit color (High Color/thousands of colors) or 24-bit color (True Color/millions of colors) recommended.
Others	• CD-ROM drive required for installation • Internet connection required for some options



- | | | | |
|--|--|---|---------------------------------|
| 1 AF-assist illuminator / Self-timer lamp / Red-eye reduction lamp | 9 USB connector / Video connector / DC-IN connector for optional EH-5 AC adapter (under cover) | 17 Menu button | 26 Delete button |
| 2 Self-timer and remote control / Reset button | 10 Flash sync mode / Flash compensation button | 18 Thumbnail / ISO (sensitivity) button | 27 Memory card access lamp |
| 3 Exposure compensation / Aperture / Flash compensation button | 11 Eyelet for camera strap | 19 Help and protect / WB (white balance) button | 28 Memory card slot cover |
| 4 Shutter-release button | 12 Mode dial | 20 Enter / QUAL (image quality/size) / Playback zoom button | 29 Multi selector |
| 5 Power switch | 13 Built-in flash | 21 Reset switch | 30 Command dial |
| 6 Infrared receiver | 14 Accessory shoe | 22 Tripod socket | 31 AE/AF lock button |
| 7 Focus-mode selector | 15 Control panel | 23 LCD Monitor | 32 Diopter adjustment control |
| 8 Lens release button | 16 Playback button | 24 Battery-chamber cover | 33 Viewfinder eyepiece cup |
| | | 25 Battery-chamber cover latch | 34 Viewfinder eyepiece |
| | | | 35 Shooting mode / Reset button |

Nikon Digital SLR Camera D50 Specifications

Type of Camera	Single-lens reflex digital camera
Effective Pixels	6.1 million
Image Sensor	RGB CCD, 23.7 x 15.6mm; total pixels: 6.24 million
Image Size (pixels)	3,008 x 2,000 [L], 2,256 x 1,496 [M], 1,504 x 1,000 [S]
Sensitivity	200 to 1600 (ISO equivalent) in steps of 1 EV
Storage Media	SD memory card
Storage System	Compressed NEF (RAW): 12-bit compression, JPEG: JPEG baseline-compliant
File System	Exif 2.21, Compliant DCF 2.0 and DPOF
Storage (Number of frames per 256MB SD Memory Card, image size L)	RAW approx. 33, FINE approx. 70 NORMAL approx. 137 BASIC approx. 258, RAW & BASIC approx. 29
White Balance	Auto (TTL white balance with 420-pixel RGB sensor), six manual modes, preset white balance, white balance bracketing possible
LCD Monitor	2.0-in., 130,000-dot, low-temperature polysilicon TFT LCD with brightness adjustment
Playback Function	1 frame: Thumbnail (4 or 9 segments); Magnifying playback; Slide show; Histogram indication; Highlight point display; Auto image rotation
Delete Function	Card format, All frames delete, Selected frames delete
Video Output Interface	Can be selected from NTSC and PAL USB 2.0 (Hi-Speed)
Text Input	Up to 36 characters of alphanumeric text input available with LCD monitor and multi-selector; stored in Exif header
Compatible Lenses	1) DX Nikkor: All functions supported 2) Type G or D AF Nikkor: All functions supported 3) Micro Nikkor 85 mm F2.8D: All functions supported except autofocus and some exposure modes 4) Other AF Nikkor: All functions supported except 3D Color Matrix Metering II 5) AI-P Nikkor: All functions supported except 3D Color Matrix Metering II and autofocus 6) Non-CPU: Can be used in exposure mode M, but exposure meter does not function; electronic range finder can be used if maximum aperture is f/5.6 or faster Note: IX Nikkor lenses can not be used
Picture Angle	Equivalent in 35mm [135] format is approx. 1.5 times lens focal length
Viewfinder	Fixed eye-level penta-Dach-mirror type; built-in diopter adjustment (-1.6 to +0.5m ⁻¹)
Viewfinder Magnification	18mm (-1.0m ⁻¹)
Viewfinder Information	Type-B BriteView Clear Matte screen Mark V with superimposed focus brackets
Viewfinder Frame Coverage	Approx. 95%
Viewfinder Magnification	Approx. 0.75x with 50mm lens at infinity; -1.0m ⁻¹
Viewfinder Information	Focus indications, AE/FV lock indicator, Shutter speed, Aperture value, Exposure/Exposure compensation indicator, Flash output level compensation, Exposure compensation, Number of remaining exposures, Flash-ready indicator
Autofocus	TTL phase detection by Nikon Multi-CAM900 autofocus module with AF-assist illuminator (approx. 0.5m to 3.0m) Detection range: EV -1 to +19 (ISO 100 equivalent, at normal temperature: 20°C)
Lens Servo	1) Autofocus (AF-A): Auto-Servo AF; camera automatically chooses single-servo AF (AF-S) or continuous-servo AF (AF-C); predictive focus tracking automatically activated according to subject status 2) AF-S 3) AF-C 4) Manual focus (M)
Focus Area	Can be selected from 5 focus areas
AF Area Mode	1) Single Area AF, 2) Dynamic Area AF, 3) Closest Subject Priority Dynamic Area AF
Focus Lock	Focus can be locked by pressing shutter-release button halfway (single-servo AF) or by pressing AE-L/AF-L button
Exposure Metering System	TTL full-aperture exposure metering system (1) 3D Color Matrix Metering II with 420-pixel RGB Sensor (2) Center-weighted: Weight of 75% (8mm dia. circle) (3) Spot: Meters 3.5mm dia. circle (about 2.5% of frame) centered on active focus area
Exposure Metering Range	1) EV 0 to 20 (3D Color Matrix or center-weighted metering) 2) EV 2 to 20 (spot metering) (ISO 100 equivalent, f/1.4 lens, 20°C)
Exposure Mode	Digital Vari-Program (Auto, Portrait, Landscape, Child Sports, Close up, Night portrait), Programmed Auto [P] with flexible program; Shutter-Priority Auto [S]; Aperture Priority Auto [A]; Manual [M]

Exposure Compensation	±5 EV in increments of 1/3 or 1/2 EV
Auto Exposure Lock	Luminosity locked at detected value with AE-L/AF-L button
Auto Exposure Bracketing	Three frames ±2 EV in 1/3 or 1/2 steps
Shooting Modes	1) Single frame shooting mode 2) Continuous shooting mode: approx. 2.5 frames per second 3) Self-timer mode 4) Delayed remote mode: 2 sec. delay 5) Quick-response remote mode
Shutter	Combined mechanical and CCD electronic shutter, 30 to 1/4000 sec. in steps of 1/3 or 1/2 EV, bulb
Sync Contact	X-contact only; flash synchronization at up to 1/500 sec.
Flash Control	1) TTL: TTL flash control by 420-pixel RGB sensor Built-in Speedlight: i-TTL Balanced Fill-Flash or standard i-TTL flash (spot metering) SB-800 or 600: i-TTL Balanced Fill-Flash or standard i-TTL flash (spot metering) 2) Auto aperture: Available with SB-800 with CPU lens 3) Non-TTL Auto: Available with Speedlights such as SB-800, 80DX, 28DX, 28, 27, and 22s 4) Distance-priority manual available with SB-800
Flash Sync Mode	1) Front-curtain Sync (normal sync), 2) Red-eye Reduction, 3) Red-eye Reduction with Slow Sync, 4) Slow Sync, 5) Rear-curtain Sync
Built-in Speedlight	: auto flash with auto pop-up [P], [S], [A], [M]: manual pop-up with button release Guide number (ISO 200/ISO 100, m): approx. 15/11 (manual full 17/12)
Flash Compensation	-3 to +1 EV in increments of 1/3 or 1/2 EV
Accessory Shoe	Standard ISO hot-shoe contact with safety lock provided
Self-timer	Electronically controlled timer with 2 to 20 seconds duration
Remote Control	Wireless Remote Control ML-L3 (optional)
Power Source	One Rechargeable Li-ion Battery EN-EL3a or EN-EL3a, AC Adapter EH-5 (optional)
Tripod Socket	1/4 in. (ISO1222)
Dimensions (W x H x D)	Approx. 133 x 102 x 76mm
Weight	Approx. 540g without battery, memory card or Body cap
Supplied Accessories*	Rechargeable Li-ion Battery EN-EL3a, Quick Charger MH-18a, Video Cable, USB Cable UC-E4, Strap, Body cap, Eyepiece Cap DK-5, Rubber Eyecup DK-20, Accessory shoe cover, PictureProject CD-ROM
Optional Accessories	Rubber Eyecup DK-20, Accessory shoe cover, PictureProject CD-ROM Rechargeable Li-ion Battery EN-EL3a/3e, Multi Charger MH-19, Quick Charger MH-18a, AC Adapter EH-5, Speedlight SB-800/600/R200, Wireless Speedlight Commander SU-800, Eyepiece Magnifier DG-2, Angle Finder DR-6, Capture NX Software, Wireless Remote Control ML-L3, Semi-Soft Case CF-D50

*Supplied accessories may differ in each country or area.

The following SD memory cards have been tested and approved for use in the D50:

- SanDisk 64MB, 128MB, 256MB, 512MB, 1GB, 2GB
- Toshiba 64MB, 128MB, 256MB, 512MB
- Panasonic 64MB, 128MB, 256MB, 512MB, 1GB, 2GB

Image Quality, Image Size and Number of Available Shots (when using a 256MB SD memory card)

Image Quality	Image Size	File Size (MB) ^{*1}	No. of Available Shots	Number of Consecutive Shots Available ^{*2}	
				Long Exp. NR Off	Long Exp. NR On
NEF (RAW)	—	Approx. 5.0MB	Approx. 33 shots	4 shots	3 shots
	L	Approx. 2.9MB	Approx. 70 shots	9 shots	7 shots
JPEG Fine	M	Approx. 1.6MB	Approx. 123 shots	10 shots	8 shots
	S	Approx. 0.8MB	Approx. 258 shots	19 shots	17 shots
	L	Approx. 1.5MB	Approx. 137 shots	12 shots	10 shots
JPEG Normal	M	Approx. 0.8MB	Approx. 233 shots	16 shots	14 shots
	S	Approx. 0.4MB	Approx. 464 shots	27 shots	25 shots
	L	Approx. 0.8MB	Approx. 258 shots	19 shots	17 shots
JPEG Basic	M	Approx. 0.4MB	Approx. 423 shots	27 shots	25 shots
	S	Approx. 0.2MB	Approx. 770 shots	49 shots	47 shots
	L	Approx. 5.8MB ^{*3}	Approx. 29 shots	4 shots	3 shots

*1 File size varies according to shooting conditions and make of memory card.

*2 Maximum number of frames that can be stored in memory buffer. Actual number of photos that can be taken before buffer fills may vary with make of memory card.

*3 Total file size of NEF (RAW) and JPEG images.

Online Video Tutorial - Digitutor
http://www.nikondigitutor.com/index_eng.html

◆ Microsoft® and Windows® are either registered trademarks or trademarks of Microsoft Corporation in the United States and/or other countries. ◆ Macintosh® is a registered trademark or a trademark of Apple Computer Inc. in the United States and/or other countries. ◆ The SD logo is a trademark. ◆ Products and brand names are trademarks or registered trademarks of their respective companies. ◆ Images on LCDs and monitors shown in this brochure are simulated.



Specifications and equipment are subject to change without any notice or obligation on the part of the manufacturer. June 2006 © 2005-6 NIKON CORPORATION



WARNING TO ENSURE CORRECT USAGE, READ MANUALS CAREFULLY BEFORE USING YOUR EQUIPMENT. SOME DOCUMENTATION IS SUPPLIED ON CD-ROM ONLY.



NIKON CORPORATION
Fuji Bldg., 2-3, Marunouchi 3-chome, Chiyoda-ku,
Tokyo 100-8331, Japan
<http://nikonimaging.com/>