



## **Plustek SmartOffice PL1530**

Two USB port for sharing in 2 PC  
One Button Press – Scan to Searchable PDF

### **Complete Your Scanning with One Touch**

How to decrease and manage messed paper documents in the process of any industry? The **Plustek SmartOffice PL1530** scanner helps you easily convert paper into digital formats and to reach “information sharing” with “security concerns”. Scan to Searchable PDF is an easy-to-use tool that helps you convert your paper documents into industry standard PDF format. With this scanner, you can just insert the paper, press the “PDF” button, and the document will be automatically converted to Searchable PDF format and saved. In addition to TWAIN and WIA support, you can also convert a folder of images to PDF.

### **Making Process Possible and Efficient**

Documents scanning, editing, filing and archive management can be simplified by using the **Plustek SmartOffice PL1530**. With the functionality of automatic document feeder and flatbed, it is easy for the staff to handle a lot of documents scan in different sizes. Specific design of two USB ports for sharing in two PCs makes it cost saving and

best suited for small business office use. This scanner is great idealistic for Government departments, enterprises, organizations and distributed branch offices use.

### **Auto-detection for ADF and Flatbed**

Let the **Plustek SmartOffice PL1530** enhance your business! With auto-detection for ADF and flatbed, it is intelligent scanning and electronic filing solution for you to scan any documents easily and conveniently. It allows you to directly scan to searchable PDF with the features of auto-size, auto-crop, auto-deskew, continuous scan, blank page removal, and Color Dropout (Red / Green / Blue). All documents can be easily digitalized for you to store, reorganize, edit, and also sharing with workgroup instantly. Improved color accuracy enhances images for much truer and more consistent colors. It can simplify all your daily work, especially well suits for the centralized digital database sharing to distributed branch offices and workgroup users.

# Plustek SmartOffice PL1530

Two USB port for sharing in 2 PC  
One Button Press – Scan to Searchable PDF

All business processes that need to archive documents and scan in reports can use this scanner to implement the low cost digital document management solutions. Both business cards and legal-size documents can be scanned to digital files and management with the **Plustek SmartOffice PL1530**, and it suits for departments in headquarters, branch offices and distributed work-groups, like law firms, CPA firms, education, hospitals, financial institutions, healthcare, and government. It really makes the most of your scanning budget to provide maximum utility with minimum effort.

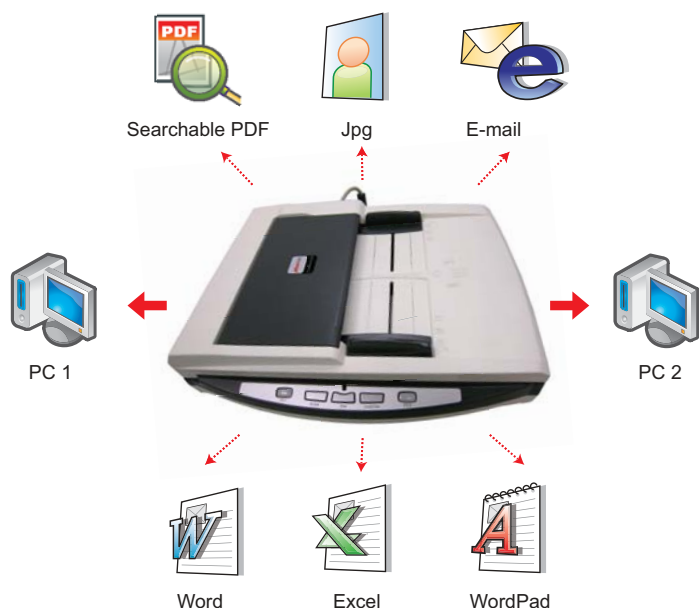

## Key Features

- Auto-detection for ADF/Flatbed
- Two USB port for sharing in 2 PC
- 15 PPM/ 30 IPM @200 dpi Grayscale mode
- 50-sheet Automatic Document Feeder Capacity
- Business card to legal size documents scanning
- Energy Star Certificated, Power Saving (No Warm Up Needed)
- 5 Single-Touch Function Buttons: PC1, Scan, PDF, Custom, PC2
- Simplex and Duplex Color Scanning in Color, Grayscale and B/W
- Capable of Scan to Searchable PDF and Multi Tiff File Format Support
- TWAIN and WIA Drivers – Allows Full Document Management Solutions Implementations

## Software Bundled

## System Requirements

IBM Compatible PC, with Pentium III 1G or faster CPU / CD-ROM Driver / One available USB Port / 256 MB RAM (512 MB or higher recommended) / 800 MB free HDD space (1 GB or larger recommended) / High Color graphic card (VGA or higher) / Windows XP Home Edition, Windows XP Professional, Windows 2000, Windows Vista, Windows 7

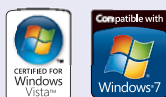

## Specification

Scanning Type	Color Contact Image Sensor (CIS)
Optical Resolution	600 dpi
Scan Modes	Color: Input 48-bit; Output 24-bit Grayscale: Input 16-bit; Output 8-bit Black & White: 1-bit
ADF Feeder Capacity	50 sheets (A4/Letter, 70 g/m <sup>2</sup> or 18 Lbs)
ADF Scanning Speed	15 PPM / 30 IPM 200 dpi @A4, grayscale mode
ADF Scanning Area (W x L)	Maximum 220 x 356 mm (8.66" x 14") Minimum 13.2 x 13.2 mm (0.52" x 0.52")
ADF Acceptable Paper Size (W x L)	Maximum 220 x 356 mm (8.66" x 14") Minimum 90 x 50.8 mm (3.55" x 2")
ADF Acceptable Paper Weight	50 to 120 g/m <sup>2</sup> (14 to 32 Lbs)
Daily Duty Scan (Pages)	1000
Flatbed Scanning Area (W x L)	Maximum 216 x 297 mm (8.5" x 11.69") Minimum 12.7 x 12.7 mm (0.5" x 0.5")
Flatbed Acceptable Paper Size (W x L)	Up to A4 / Letter size (8.5" x 11.69")
Power Supply	24V, 0.75A
Environment Requirement	WEEE/ ROHS
Interface	USB 2.0 High Speed
Net Weight	3.78 Kgs (10.1 Lbs)
Dimensions (W x D x H)	418 x 326 x 101 mm (16.45" x 12.83" x 4")
Protocols	TWAIN Compliant
EMI	FCC Class B, CE



As an international ENERGY STAR partner, Plustek has determined that this product meets the international ENERGY STAR program for energy efficiency.

© 2010 by Plustek Inc. All rights reserved. All registered trademarks are the property of their respective owners.

Headquarters: sales@plustek.com.tw